



IP68 : Suitable for Underwater Locations
IK10 : Impact Resistant (Vandal Resistant)

Atlantis 2 - Surface Flood RGB

4.0" round - Underwater
Marine Grade Stainless Steel 316

A range of high quality Stainless Steel under water surface mounted floodlight Luminaires with a selection of different optics.

This surface mounted Luminaire manufactured from Marine Grade Stainless 316 and is designed for use in ponds, rock pools and water features. This luminaire is not rated for natatoriums, swimming pools or water parks.

Not only is the housing made of the highest quality stainless steel but incorporated in the product design is a unique product feature that uses a water proof potting compound that totally seals the back of the luminaire and stops water ingress.

This Luminaire is adjustable and has a tamper resistant locking feature.

Installer Friendly.

This product is be attached to the surface by securing the luminaire using the counter sink holes provided around the base of the luminaire.

The fixture is pre-wired with a 16 ft water proof cable that makes connection to the remote low voltage DMX decoder/driver a simple task. Longer power cable can be provided if specified.

RGB Controls are additional options and should be specified with the control package. Remote mounted low voltage transformer and RGB control box to be provided by contractor.

Remote mounted box provided by contractor.

Technical Data

Fixture	Marine Grade 316 Stainless Steel
Bracket	Marine Grade 316 Stainless Steel
Hardware	Marine Grade 316 Stainless Steel
Lens	Tempered Glass
Driver	24Vdc (120VAC to 24VDC low voltage transformer by others)
LED Watts	9W
LED (color)	RGB
CRI	> 85
Cable	16 foot Water Proof Cable
Approvals	ETL



Polished Finish

Dimensions

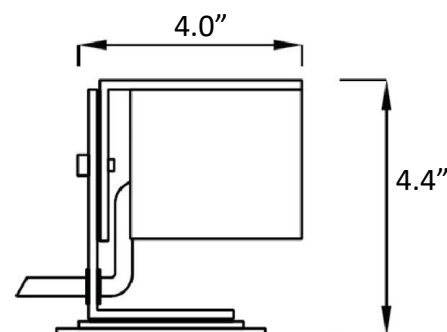

Ground Spike

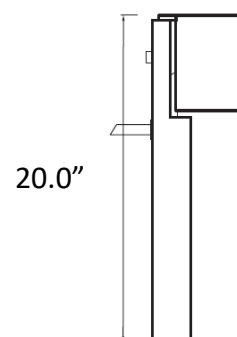

PROJECT: _____

DATE: _____

QUANTITY: _____

TYPE: _____

NOTE: _____

Atlantis 2 - Surface Flood **RGB**

4.0" round - Underwater
Marine Grade Stainless Steel 316

4.0" Diameter

Adjustable Tilt



Wattage

Model (Specify)

Lumens

9W

405431

9 RGB Watt Beam

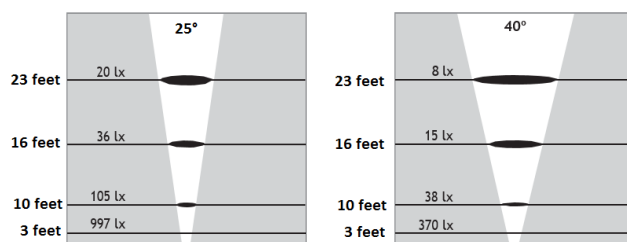
**Options****(Specify)****LED Color**

(RGB) RGB

Beam Spread(25) 25°
(40) 40°**Lens**(C) Clear
(F) Frosted**Volts**(DC) 24Vdc
(3) Other _____**Other**

(GS) Ground Spike

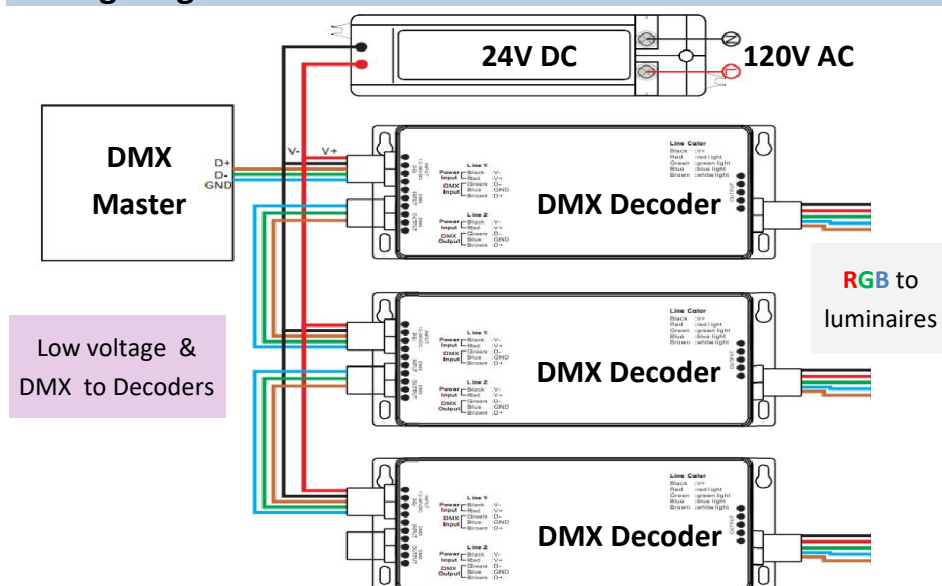
Wiring Diagram

Ordering Example : Atlantis 2 - 405431 - 9W - RGB - 25 - C - DC

Code

LED Watts

LED Color

Beam

Lens

Volts

Other

Atlantis 2 - _____

PROJECT: _____

DATE: _____

QUANTITY: _____

TYPE: _____

NOTE: _____